



# THE ASIATIC SOCIETY

Founded in 1784

(An Institution of National Importance declared by an Act of Parliament) and

(An Autonomous Organization under Ministry of Culture, Government of India)

1, Park Street, Kolkata- 700016

Phone : 2229-0779, 2249-7250, 2229-7251, Fax: 033-2252-0600

Website: [www.asiaticsocietykolkata.org](http://www.asiaticsocietykolkata.org)



Ref. No: **TASK/2024-25/LTE/001**

Dated: **24.06.2024**

## **TENDER NOTICE** **[Limited Tender Enquiry]**

### **Sub: Renovation of the Proposed Record keeping room of the Accounts Section of the Asiatic Society, Kolkata.**

\*\*\*\*\*

The Asiatic Society, Kolkata invites sealed tenders from its empanelled contractors for : Renovation of the Proposed Record keeping room of the Accounts Section of the Asiatic Society, Kolkata-700016.

2. The technical specifications of the work to be executed and other terms and conditions relating to the tender are contained in Tender Document.
3. Tender Notice will be sent through post / e-mail to the empanelled firms who are eligible to bid.
4. The Tender Notice along with Tender document will be available on the website of The Asiatic Society, Kolkata i.e. [www.asiaticsocietykolkata.org](http://www.asiaticsocietykolkata.org) and also at the e- Publishing portal of the Government of India i.e. <https://eprocure.gov.in/epublish/app>.
5. This notice is being published for information only and is not an open invitation to quote in this Limited Tender. Participation in this Tender is by invitation only and is limited to the empanelled vendors of the Society. Unsolicited offers are liable to be ignored.
6. Tender documents are to be submitted in sealed cover, complete in all respects along with all necessary enclosures to The General Secretary, The Asiatic Society, 1 Park Street, Kolkata-700016 latest by **10.07.2024** within **03.00 P.M.**
7. The Asiatic Society, Kolkata reserves the right to amend/cancel any of the terms and conditions in the Tender Document or to reject any or all tenders without giving any notice or assigning any reason.

Sd/-

Administrative Officer  
The Asiatic Society, Kolkata

# The Asiatic Society, Kolkata

## LIMITED TENDER FORM

<b>Firm's Reference</b>		<b>Date</b>		
<b>Firm Registration No. (if any)</b>		<b>PAN (attach photocopy)</b>		
<b>GST No.</b>		<b>LIMITED TENDER FORM</b>	<b>Address:</b>	
<b>Phone</b>				
<b>Fax</b>				
<b>Email</b>				
<b>M/s:</b>	<b>Enquiry No. and Date</b>	<b>TASK/2024-25/LTE/001 Dated 24.06.2024</b>		
	<b>Date of Tender Opening</b>	<b>11.07.2024</b>		
	<i>The tender will be opened at 1.00 pm on the date of tender opening above, at the address mentioned above.</i>			
<b>Please submit on or before 03.00 P.M of 10.07.2024, your quotation for the following work, in accordance with the terms and conditions printed overleaf, in a sealed cover, marked on top with - Enquiry No; Date of Tender Opening.</b>				
<b>Tender Schedule: All Rates in Figures and in Words in Rupees</b>				
<b>Sr. No</b>	<b>Description and Specification</b>	<b>Total value of the work</b>	<b>% of Higher/lower/ at par</b>	<b>Total Value</b>
	<b>The specification/estimate of the work is attached as Annexure-B</b>	<b>Rs 1,50,912</b>		
<b>Work completion Schedule: Within 10 days from the date of Work Order.</b>				
<b>The specification of the work is attached as Annexure B.</b>				
<b>Sign and Seal of the Bidder</b>				

I/we engage to the execute the works in your office and comply the following:

- 1) Tender schedule and technical specification indicated.
- 2) Item/tender specific conditions for this tender.
- 3) Terms and conditions as printed in Annexure A.
- 4) General conditions of contract signed by me at the time of contractor empanelment.
- 5) This offer is valid for 90 (ninety) days from the date of opening of the tender.
- 6) That we have not been debarred by any Government/Undertaking.
- 7) That the rates quoted are not higher than the rates quoted for same work executed in any Government/Undertaking.
- 8) That the bid submitted by us is properly sealed and prepared so as to prevent any subsequent alteration and replacement.

<b><i>Signature and seal Place &amp; Date</i></b>		<b><i>Name of Authorized Signatory :</i></b>	
<b>Address :</b>		<b>Tel. No./Fax. No/ Mobile No./ Email Id:</b>	

**Terms and Conditions of Limited Tender**

1. The quotation must be in the form furnished by Executing Entity and should be free from corrections /erasures. In case there is any unavoidable correction it should be properly attested. If not, the quotation will not be considered. Quotation written in pencil will not be considered.
2. Quotation will be opened on due date at 01.00 pm at the indicated venue in presence of the tenderers or their representatives who may wish to be present.
3. All executions are subject to inspection and approval before acceptance.
4. The prices quoted should be firm till the execution of the works is completed. Price quoted should be including all taxes and duties and valid for a minimum period of three (3) months from the opening the date of the quotations.
5. Payment in terms of 90% of the value of the Work Order will be made only within 30 days on completion of the work and submission of final GST Invoice in duplicate along with handing over and taking over note and satisfactory completion certificate received from the Maintenance Section of the Asiatic Society. The Income Tax and other statutory deductions, as applicable will be deducted from each payment. No request for advance payment will at all be entertained.
6. 10% of the value of work will be deducted as security deposit from the final bill and will be released after Six (6) months from the date of handing over and taking over of the executed work. No interest will be admissible for the security deposit.
7. In case quotation of a tenderer is accepted and work order is placed on it, the work against the order should be executed within the period stipulated in the order. The Society reserves the right to recover any loss sustained due to delayed execution of the work by way of penalty. Failure to execute the work within the stipulated period shall entitle the Society for the imposition of penalty without assigning any reasons @ 1/2% (half percent) of the total value of the work covered in order as penalty per day subject to a maximum of 5% (five percent) unless extension is obtained in writing from the office on valid ground before expiry of execution period.
8. Any dispute relating to the enquiry shall be subject to the jurisdiction of the court at Kolkata only.

**Sign and Seal of the Bidder**

**Line Sketch:**

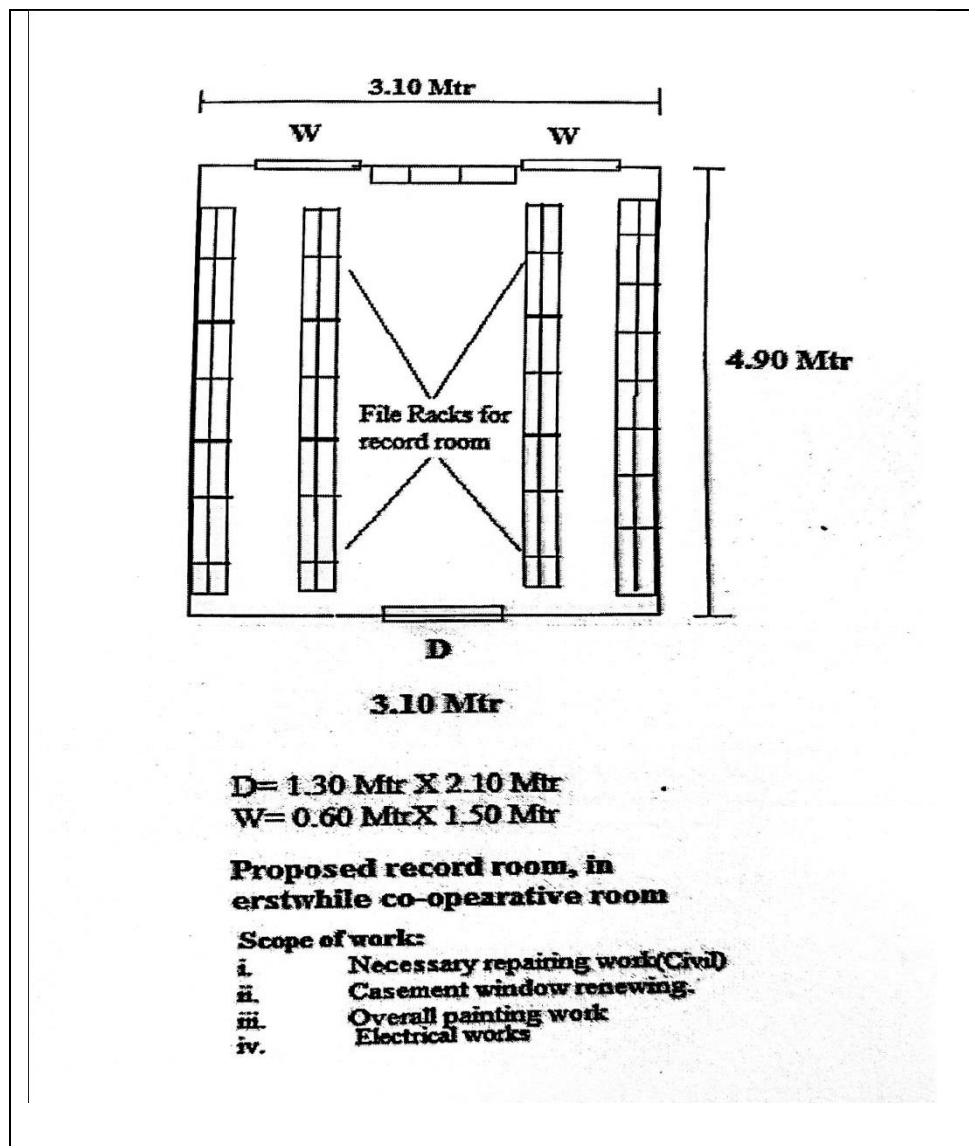

**Scope of work: (Renovation of the Proposed Record keeping room of the Accounts Section of the Asiatic Society, Kolkata.)**

- Shifting of Almirah, table, chairs and Old obsolete files and other materials.
- Dismantling of existing iron frames of the old false ceiling materials.
- Supply, fitting and fixing of a new sliding door instead of the existing door with necessary painting works and necessary locking arrangement.
- Necessary brickwork in some portion of the wall.
- Necessary plastering work on the walls.
- Painting of walls
- Replacing the damaged casement window with aluminum casement window.
- Painting of windows and others
- Necessary civil works.
- In accordance to the attached requisition necessary rack fitting work for storing and preservation of files and records of the Accounts Section.
- Making necessary wiring and light fitting.

**Preliminary Estimate (Civil)**

<b>Renovation of proposed record keeping room at 3rd floor of the New building, Asiatic Society, Kolkata 700016</b>								
<b>Item No.</b>	<b>Description of work</b>	<b>Place of work</b>	<b>Unit</b>	<b>No</b>	<b>Quantity</b>	<b>Rate</b>	<b>References of rates</b>	<b>Amount(RS)</b>
A	<b>Renovation of proposed record keeping room 3rd floor (4.90m X 3.10m)</b>							
1	Labour charges for shifting existing furniture like almirah,chair,tables etc to the vacant places.	3rd floor	Heads	Unskilled	3.00	778.00	As per GOI notification of labour and employment dated 01.04.2024	2334.00
2	Labour charges for dismantling,cutting,shifting of the old existing metal frames of false ceiling		Heads	Semi skilled	1.00	862.00	As per GOI notification of labour and employment dated 01.04.2024	862.00
							CPWD DSR 2023 Item No	
3	Diluting and injecting chemical emulsion for POST-CONSTRUCTIONAL anti-termite treatment (excluding the cost of chemical emulsion) : 2.35.1 Along external wall where the apron is not provided usingchemical emulsion @ 7.5 litres / sqm of the vertical surface ofthe substructure to a depth of 300mm including excavation channel along the wall & rodding etc. complete:							
	i. Along the external wall below concrete or masonry apron using chemical emulsion @ 2.25 litres per linear metre including drilling and plugging holes etc.: 2.35.2.1 With Chlorpyriphos/ Lindane E.C. 20% with 1% concentration	3rd floor	mtr	1	100.00	53.45	2.35.2.1	5345.00
	ii.Supplying chemical emulsion in sealed containers including delivery as specified. 2.34.1 Chlorpyriphos/ Lindane emulsifiable concentrate of 20%		ltr	1	4.00	234.75	2.34.1	939.00
4	Dismantling existing doors, windows, fixed glazing and false ceiling including disposal of unserviceable material and stacking of serviceable material with in 50 meters lead as directed by Engineer-in-charge.		Sqm		4.53	56.35	15.57 26.28.2	255.27
5	Chipping of unsound/weak concrete material from slabs, beams,columns etc. with manual Chisel and/ or by standard power driven percussion type or of approved make including tapering of all edges, making square shoulders of cavities including cleaning the exposed concrete surface and reinforcement with wire brushes etc. and disposal of debris for all lead and lifts all complete as per direction ofEngineer-In-Charge(Total jamb for one window 1.2m X 0.15m=0.18 sqm ,lintel 0.18 sqm on an avg thknss		sqm	1	4.53	256.35		1161.27
6	Dismantling old plaster or skirting raking out joints and cleaning the surface for plaster including disposal of rubbish to the dumping ground within 50 metres lead.(5.51m + 2.81 m) x 3.03=25.2sqm ,(less 11.15sqm ) Equal to= 14.05sqm		Sqm	1	54.65	45.05	15.56	2461.98
7	Providing, mixing and applying bonding coat of approved adhesive on chipped portion of RCC as per specifications and direction of Engineer-In-charge complete in all respect. SBR Polymer (@ 10% of cement weight) modified cementitious bond coat @ 2.2 kg cement per sqm of surface area mixed with specified proportion of approved polymer		sqm	1	4.53	141.2	26.31.1	639.64
9	Centering and shuttering including strutting, propping etc. and removalof form work for :Retaining walls, return walls, walls (any thickness) includingattached pilasters, buttresses, plinth and string courses fillets, kerbs and steps etc(4.55 m x 2.81 m)=12.78sqm		sqm	1	4.53	842.5	4.3.2	3816.53
10	20 mm cement plaster of mix : 1:4 (1 cement: 4 fine sand) for finishing of R.C.C members		sqm	1	2.5	471.35	13.3.1	1178.38

11	Repairs to plaster of thickness 12 mm to 20 mm in patches of area 2.5 sq.meters and under, including cutting the patch in proper shape, raking out joints and preparing and plastering the surface of the wall complete, including disposal of rubbish to the dumping ground, all complete		Sqm		51.24	547.4	14.1.1	28048.78
12	Providing and applying white cement based putty of average thickness 1 mm, of approved brand and manufacturer, over the plastered wall surface to prepare the surface even and smooth complete total area of plaster portion 14.05 sqm		sqm		51.24	156.05	13.8	7996.00
13	Applying priming coats with primer of approved brand and manufacture, having low VOC (Volatile Organic Compound) content With water thinnable cement primer on wall surface having VOC content less than 50 grams/litre		Sqm		69.06	73.95	13.85.3	5106.99
14	Wall painting with premium acrylic emulsion paint of interior grade, having VOC (Volatile Organic Compound) content less than 50 grams/ litre of approved brand and manufacture, including applying additional coats wherever required to achieve even shade and colour. (equal area of wall putty)						13.83.2	
	13.83.2 Two coats		sqm		69.06	142.8		9861.77
15	Applying priming coat to steel surface							
16	Providing and fixing double glazed hermetically sealed glazing in aluminium windows, ventilators and partition etc. with 6 mm thick clear float glass both side, having 12 mm air gap, including providing EPDM gasket, perforated aluminium spacers, desiccants, sealant (Both primary and secondary sealant) etc. as per specifications, drawings and direction of Engineer-in-charge complete.		Sqm		1.80	4997.7	21.1	8995.86
	With ready mixed red oxide zinc chromate primer of approved brand and manufacture on steel galvanised iron/ steel works		sqm		6.33	67.4	13.50.3	426.64
17	Painting with synthetic enamel paint of approved brand and manufacture to give an even shade : Two or more coats on new work		Sqm		6.33	155.9	13.61.1	986.85
18	Providing and fixing T-iron frames for doors, windows and ventilators of mild steel Tee-sections, joints mitred and welded, including fixing of necessary butt hinges and screws and applying a priming coat of approved steel primer. 10.13.1 Fixing with 15x3 mm lugs 10 cm long embedded in cement		kg		60	141.70	10.13.1	8502.00
19	Providing and fixing 1 mm thick M.S. sheet sliding-shutters, with frame and diagonal braces of 40x40x6 mm angle iron, 3 mm M.S. gusset plates at the junctions and corners, 25 mm dia pulley, 40x40x6 mm angle and T-iron guide at the top and bottom respectively, including applying a priming coat of approved steel primer		Sqm		2.73	6566.2	10.4	17925.73
20	Labour charges for a. Dismantling of existing racks at ground floor publication stack. B. Carrying the materials from ground floor to 3rd floor C. Stacking the rack materials D. Re-fitting the racks with necessary arrangements.							
			Heads	Unskilled	10.00	778.00	As per GOI notification of labour and employment dated 26.09.2023	7780.00
			Heads	Semi skilled	5.00	862.00	As per GOI notification of labour and employment dated 26.09.2023	4310.00
							Add 15% CP+OH for basic labour charges i.e Rs 15286.00 By considering item 1,2,20	2292.9
							<b>Grand Total(Rs)</b>	<b>123804.81</b>
						(A)	<b>Say(Rs)</b>	<b>123805.00</b>

**(Rupees one lakh twenty three thousand eight hundred five)**

**Preliminary Estimate (Electrical)**

Sl No	Item Description	Qty	Unit	Rate	Amount	Remarks
<b>1.</b>	<b>Sub – Head : Wiring</b>					DSR 2022
<b>1.1</b>	<b>Labour charges for taking out existing electrical fittings as directed by EIC</b>	2	Skilled	862		GOI notification of labour ministry dated 01.04.2024
		2	Unskilled	778	1556.00	
1.1	Wiring for light point/ fan point/ exhaust fan point/ call bell point with 1.5 sq.mm FRLS PVC insulated copper conductor single core cable in surface / recessed medium class PVC conduit, with modular switch, modular plate, suitable GI box and earthing the point with 1.5 sq.mm FRLS PVC insulated copper conductor single core cable etc. as required. <b>Group - C</b>	6	point	1467	8802.00	1.10.1
1.2	Wiring for circuit/ sub main wiring along with earth wire with the following sizes of FRLS PVC insulated copper conductor, single core cable in surface/ recessed PVC conduit as required.					1.14
	a) 2 x 1.5 sq.mm + 1 x 1.5 sq.mm earth wire	20	mtr	233	4660.00	1.14.1
	b) 2 x 4 sq.mm + 1 x 4 sq.mm earth wire	10	mtr	334	3340.00	1.14.3
1.3	Supplying and fixing following sizes / moduler PVC Box along with moduler base & cover plate for moduler switches and socket in recess / surface etc. as required.					
	a)4 Module (125mmX75mm)	2	No	343	686.00	1.27.3
1.4	Supplying and fixing following moduler switch / socket on the existing moduler plate & switch box including connection buy excluding moduler plate etc. as required.					
	a) 5/6 amp switch	5	Nos.	103	515.00	1.24.1
	b) 3/5 pin 5/6 amp socket outlet	1	Nos.	122	122.00	1.24.4
	c) 15/16 amp switch	1	Each	156	156.00	1.24.3
	d) 15/16 amp socket	1	Each	197	197.00	1.24.5
	f) Blank Plate	2	Nos.	50	100.00	MR
1.6	Supplying and fixing 5-32 amps rating, Single Pole, 240 volts, "C" curve, miniature circuit breaker suitable for inductive load of following poles in the existing SPN MCB DB complete with connections, testing and commissioning etc. as required.					
	a) 5 to 32 amp	1	Nos.	556	556.00	1.10.1
1.7	Item Procurement					
	Supply, fitting, fixing 4 no of LED light fitting of 40watt	4	Nos	800	3200.00	
	Supply ,fitting, fixing one no of exhaust fan	1	No	1000	1000.00	
				<b>TOTAL (Rs)</b>	<b>26,614.00</b>	
				Add 15% CP+OH on labour charges	<b>492.60</b>	
				<b>GRAND TOTAL(Rs)</b>	<b>27,106.60</b>	
				<b>Say(Rs)</b>	<b>27,107.00</b>	<b>(B)</b>

**Therefore, Total Value of the Work after consideration of Civil (A) and Electrical (B) Work is Rs= (1, 23,805 + 27,107) = Rs 1, 50,912.00 (Rupees one lakh fifty thousand nine hundred twelve) only.**



